

757CS

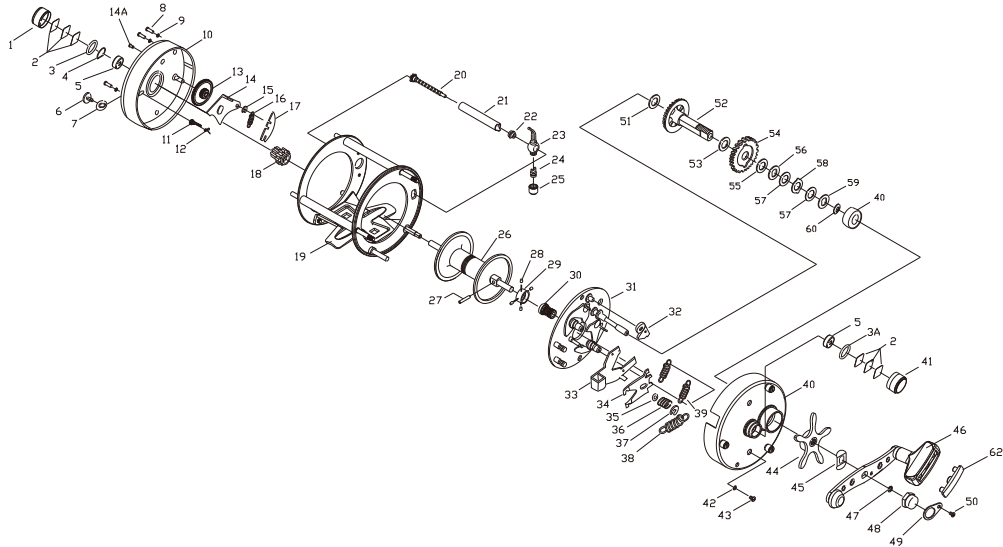

NO	Part Name	Part Code	NO	Part Name	Part Code	NO	Part Name	Part Code
1	Left cast control cap	7062-1	21	Line guide	6915	42	Protecting washer(x2)	L7100
2	Base washer(x6)	5145	22	Bushing	5173	43	Screw(x2)	246
3	O-ring	5229	23	Level wind assembly	6918,22002	44	Star drag	22631-1,20065,20080-1
3A	O-ring	5229-1	24	Level wind pawl	5176	45	Spacer	6970
4	Locking	5142	25	Level wind nut	5177	46	Single handle assembly	50002-2,7008-1 TW20L-3053 7006-5-2,37191-1
5	Ball bearing(x2)	4*10*4	26	Spool assembly	24538,21079-1	47	E.Clip	8846
6	Click switch	8744-1	27	Pin	6958	48	Handle nut	6968
7	Washer	8904	28	Brake pin	1881	49	Handle nut retainer	4581
8	Screw(x3)	199	29	Brake centre assembly	6937,6988	50	Handle nut retainer screw	8907
9	Washer(x3)	L7098	30	Pinion	6941,6942,21100	51	Spring washer	6969
10	Left side plate	4203-4,4491,6890 81705-2,7057	31	Brake plate assebmly	6921-3,6922,6923 6924,6925,6926 6927,6928,6929 6938,6939-1	52	Drive shaft assembly	6944,6945,6946
11	Click pawl	8745	32	A/R pawl	4611,5518,5578	53	Drive washer	6950
12	Click pawl spring	4464	33	Release trigger	6934,6937	54	Main gear assembly	6948,6949
13	Oscillation cog. wheel	19754	34	Clutch arm	20877	55	Drag washer	6951
14	Click retainer	4467	35	Washer	KAM-5053	56	Key washer	6953
14A	Rivet	4468	36	Coil spring	9741	57	Drag washer	6952
15	E-Clip	3909	37	Retainer	8845	58	Eared friction washer	6954
16	Spring	24390	38	Spring to release trigger	6936	59	Key washer	TW20L-3025
17	Lock plate	5178	39	Spring to lockhandle(x2)	6930	60	Spring washer	TW20L-3045-1
18	Line alarm cog wheel	8703	40	Right side plate assembly + one-way bearing	80001,6972-4,6992 21593-2,5326,L7099	62	Handle knob cap	37192
19	Frame assembly	6907,6908,4309 6902-3,6905,6904-1 6906,6903-3,6910,6909	41	Right cast control cap	7064-1			
20	Worm shaft assembly	6913,6914,5170						

757CT

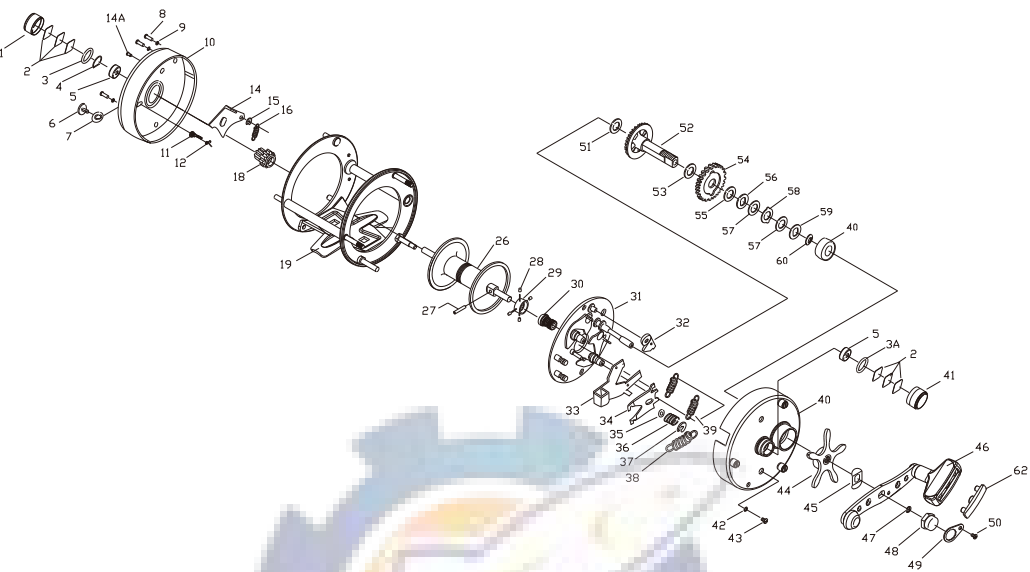

NO	Part Name	Part Code	NO	Part Name	Part Code	NO	Part Name	Part Code
1	Left cast control cap	7062-1	19	Frame assembly	6907,6908,4309 6902-3,6905,6904-1 6903-3,6910,6909	42	Protecting washer(x2)	L7100
2	Base washer(x6)	5145	26	Spool assembly	24538,21079-1	43	Screw(x2)	246
3	O-ring	5229	27	Pin	6985	44	Star drag	22631-1,20065,20080-1
3A	O-ring	5229-1	28	Brake pin	1881	45	Spacer	6970
4	Locking	5142	29	Brake centre assembly	6987,6988	46	Single handle assembly	50002-2,7008-1 TW20L-3053 7006-5-2,37191-1
5	Ball bearing(x2)	4*10*4	30	Pinion	6941,6942,21100	47	E.Clip	8846
6	Click switch	8744-1	31	Brake plate assembly	6921-3,6922,6923 6924,6925,6926 6927,6928,6929 6938,6939-1	48	Handle nut	6968
7	Washer	8904	32	A/R pawl	4611,5518,5578	49	Handle nut retainer	4581
8	Screw(x3)	199	33	Release trigger	6934,6937	50	Handle nut retainer screw	8907
9	Washer(x3)	L7098	34	Clutch arm	20877	51	Spring washer	6969
10	Left side plate	4203-4,6890 81705-2,7057	35	Washer	KAM-5053	52	Drive shaft assembly	6944,6945,6946
11	Click pawl	8745	36	Coil spring	9741	53	Drive washer	6950
12	Click pawl spring	4464	37	Retainer	8845	54	Main gear assembly	6948,6949
13	Oscillation Cog. wheel	19754	38	Spring to release trigger	6936	55	Drag washer	6951
14	Click retainer	4467	39	Spring to lockhandle(x2)	6930	56	Key washer	6953
14A	Rivet	4468	40	Right side plate assembly +one-way bearing	80001,6972-4,6992 21593-2,5326,L7099	57	Drag washer	6952
15	E-Clip	3909	41	Right cast control cap	7064-1	58	Eared friction washer	6954
16	Spring	24390				59	Key washer	TW20L-3025
18	Line alarm cog wheel	8703				60	Spring washer	TW20L-3045-1
						62	Handle knob cap	37192

757CTM

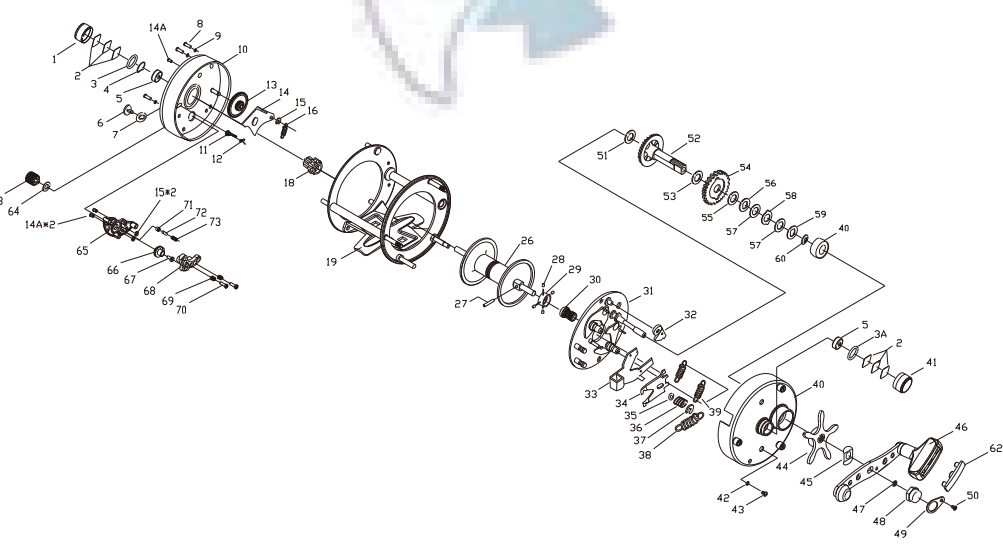

NO	Part Name	Part Code	NO	Part Name	Part Code	NO	Part Name	Part Code
1	Left cast control Cap	7062-1	29	Brake centre assembly	6987,6988	50	Handle nut retainer screw	8907
2	Base washer(x6)	5145	30	Pinion	6941,6942,21100	51	Spring washer	6969
3	O-ring	5229	31	Brake plate assembly	6921-3,6922,6923 6924,6925,6926 6927,6928,6929 6938,6939-1	52	Drive shaft assembly	6944,6945,6946
3A	O-ring	5229-1	32	A/R pawl	4611,5518,5578	53	Drive washer	6950
4	Locking	5142	33	Release trigger	6934,6937	54	Main gear assembly	6948,6949
5	Ball Bearing(x2)	4*10*4	34	Clutch arm	20877	55	Drag washer	6951
6	Click switch	8744-1	35	Washer	KAM-5053	56	Key washer	6953
7	Washer	8904	36	Coil spring	9741	57	Drag washer	6952
8	Screw(x3)	199	37	Retainer	8845	58	Eared friction washer	6954
9	Washer(x3)	L7098	38	Spring to release trigger	6936	59	Key washer	TW20L-3025
10	Left side plate	4203-4,6890 81705-2,7057	39	Spring to lockhandle(x2)	6930	60	Spring washer	TW20L-3045-1
11	Click pawl	8745	40	Right side plate assembly + one-way bearing	80001,6972-4,6992 21593-2,5326,L7099	63	Switch	66313
12	Click pawl spring	4464	41	Right cast control cap	7064-1	64	Washer	66316
13	Oscillation cog. wheel	19754	42	Protecting washer(x2)	L7100	65	Magnetic seat	66314
14	Click retainer	4467	43	Screw(x2)	246	66	Lifter	66312
14A	Rivet(x3)	4468	44	Star drag	22631-1,20065,20080-1	67	Screw	246
15	E-Clip(x3)	3909	45	Spacer	6970	68	Magnetic assembly	66311,HD-6311
16	Spring	24390	46	Single handle assembly	50002-2,7008-1 TW20L-3053 7006-5-2,37191-1	69	Spring (x2)	HD-6309
18	Line alarm cog wheel	8703	47	E.Clip	8846	70	Screw(x2)	1-48
19	Frame assembly	6907,6908,4309 6902-3,6905,6904-1 6903-3,6910,6909	48	Handle nut	6968	71	Click	66315
26	Spool assembly	24538,21079-1	49	Handle nut retainer	4581	72	Pin	66317
27	Pin	6985				73	Spring	66318
28	Brake pin	1881						



www.akiosfishingtackle.com



Congratulations on your purchase of an AKIOS Reel. AKIOS Reels are simple to operate, even though they are precision machined instruments. Before using your AKIOS Reel, please take a few moments to read this instruction guide as it will help you to get the best performance.

WARRANTY:AKIOS warrants to the original purchaser that this product will be free from non-conformities in material or workmanship for the period of one year from the date of purchase. Please keep your receipt for all warranty claims. To request warranty repairs ,register your purchase and to activate your warranty please log onto our website at www.akiosfishingtackle.com and follow instructions under the heading "Warranty". Once registered your reel is covered under it's 12 month warranty from date of purchase with a valid dated receipt of proof of purchase.To request a warranty repair on your Akios reel please follow details on our website under "Warranty". If you need to contact us please do so through "Contact Us" on webite or write to P.O.Box 167 Stockport SK7 9AN England

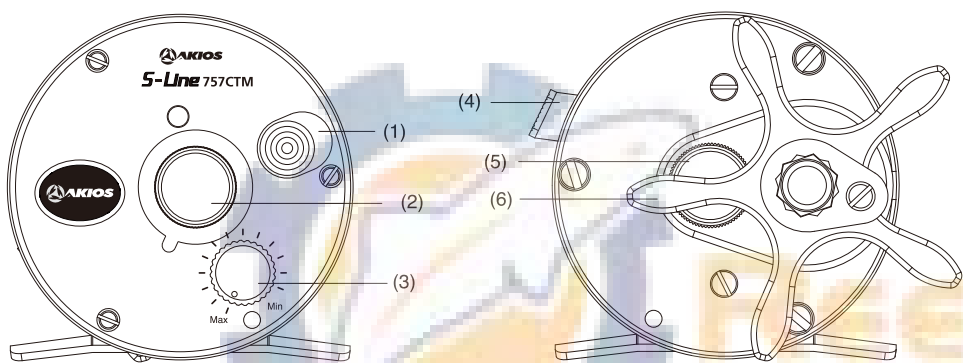

- | | |
|---------------------------------|------------------------------|
| (1) Spool click | (4) Free spool button |
| (2) Mechanical brake (Left) | (5) Mechanical brake (Right) |
| (3) Mag brake (Selected models) | (6) Adjustment star for drag |

MAG BRAKE (selected models):

Akios Mag Brake is a fully adjustable magnetic brake that can be set to help reduce the possibility of over-runs on the spool during casting. If you are using a Mag Braked reel for the first time add more mag brake power to the spool which will limit casting distance, but as you become more confident you can reduce the mag setting and the distances will increase. The mag brake can also be a great assistance when conditions change and you have strong headwinds for example or you choose to fish with larger baits.

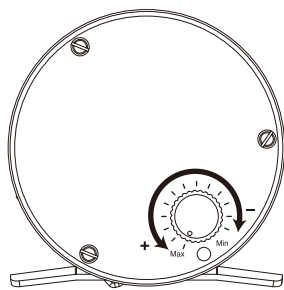

MECHANICAL BRAKE (Right side)

For maximum casting distance and minimal tendency to over run it is necessary to adjust the mechanical brake and is a case of trial and error dependant on bait,weight or lure being used. Adjust brake a little at a time to balance spool so the spool is set against weight,bait or lure when on line.

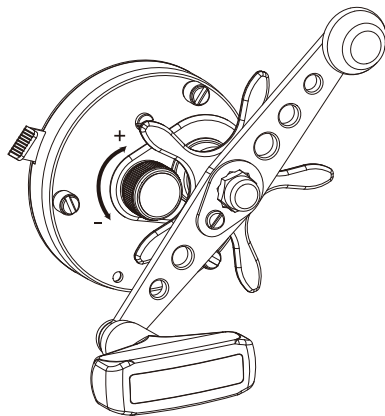

CENTRIFUGAL BRAKE

Centrifugal brake weights are snapped onto retainer pins attached to the spool. As the spool spins, centrifugal force creates pressure from the weights on the brake drum attached to the frame.This pressure helps prevent the spool from over running at the start of the cast. Be sure to slide the brake weights inward on their pins before re-assembling your reel.

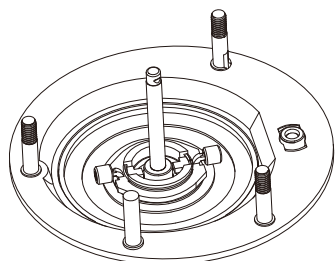

MECHANICAL BRAKE (Left side)

The Mechanical brake adjustment on the left side plate and the centrifugal brake work together to virtually eliminate backlash.The speed of spool rotation and side play are adjustable with the calibrated dial on the side plate which serves as a memory device in matching various bait, line and rod combinations.

Starting with the scale set at the "0"position, gradually increase the setting until you reach the proper setting suited to your casting ability.

Note: All adjustments should be made by using the brake control on the left side plate on the reels.

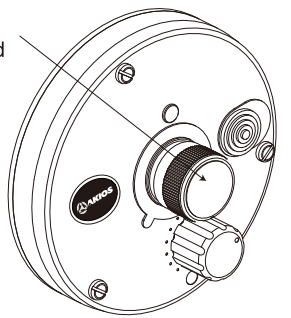

DRAG-FOR HOOKING AND CONTROLLING HOOKED FISH

Set by turning the adjustment star on the side of the reel handle, the drag should be adjusted to approximately one third of the breaking test of the line being used. This is best done by tying the line to scales for precise adjustment. Be sure reel is first mounted on a rod and the line run through rod guides before tying to scales. The drag should always be released before the line reaches its breaking point. Some techniques require higher settings. Any adjustment above half the line strength risks line breakage.

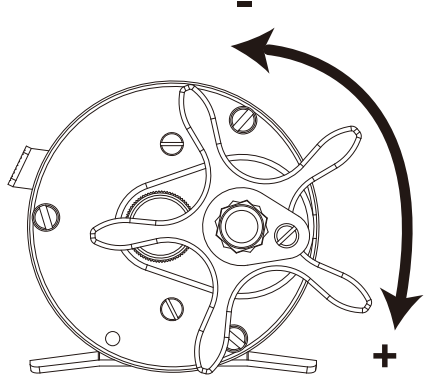

SPOOL CLICK

This simple on-off slide switch engages an audible alarm to alert the angler that line is moving from the spool. Most used when trolling or still fishing Alarm must be disengaged when casting and should also be released when retrieving or fighting a fish.

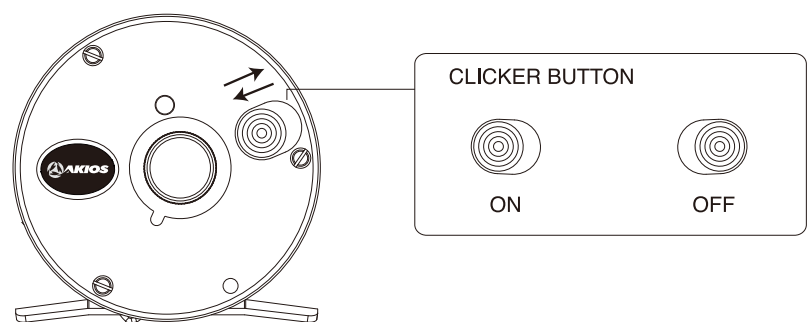

BASIC CASTING

With a multiplier, clamp the thumb of your rod hand hard on the spool to stop it turning, and put the reel into free-spool mode, by depressing the free spool button on right hand side plate.

LINE CONTROL:

To slow down a hooked fish on a multiplier, apply gentle thumb pressure to the revolving spool (but beware of friction burns), overruns are rare with modern reels because they have magnetic braking systems.

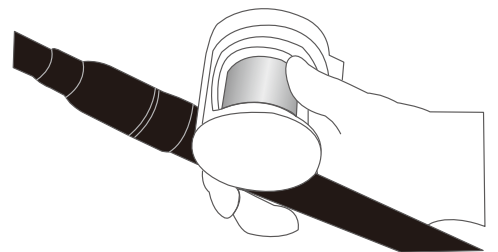

MAINTENANCE

As with any piece of precision product, your AKIOS will require regular maintenance. Lack of this could void warranty. To keep your reel working at peak efficiency, it should be cleaned and lubricated after each use. Gently rinse the reel in fresh water, wipe it dry and lubricate according to the accompanying chart. At least once a season your reel should be disassembled for a a thorough cleaning and re-lubrication. Refer to the exploded parts view supplied with your reel.

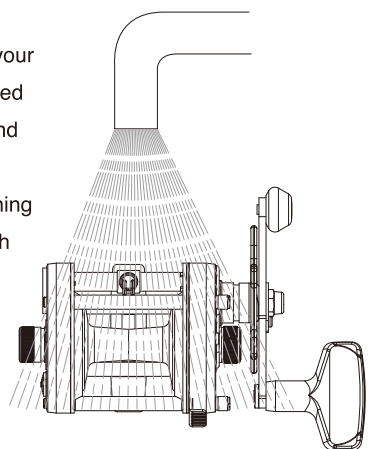

Lubrication:

